

# INSTALLATION AND SERVICE MANUAL

**LIGMAN**  
NORTH AMERICA

For installation of Quantum 2 Medium Floodlight Pedestal Mounting Base.  
Model. UQA-50011-PKM

## PRODUCT DRAWING (DIMENSIONS)

SUITABLE FOR WET LOCATIONS

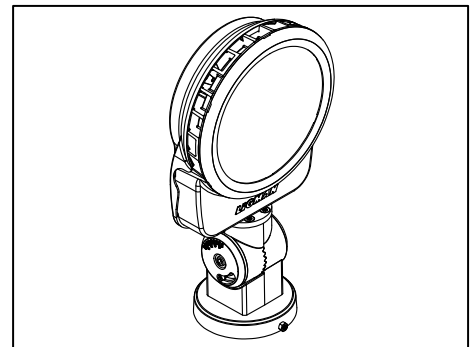
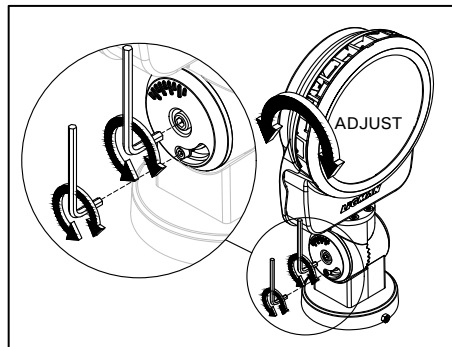
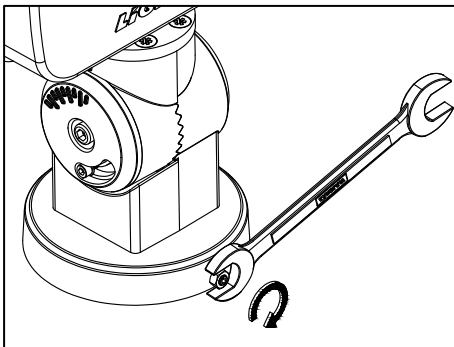
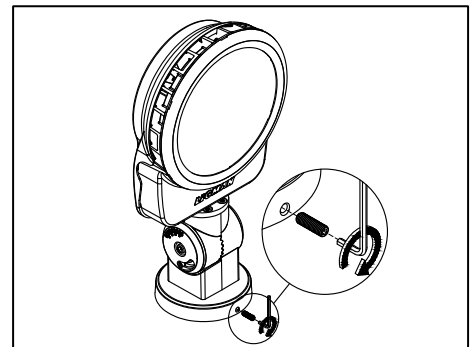
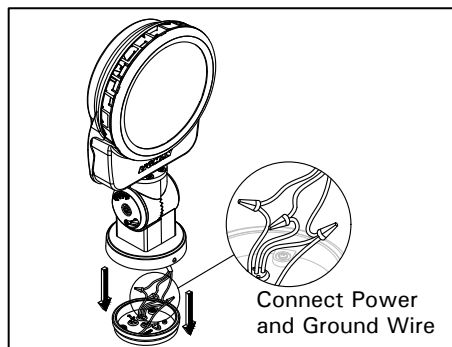
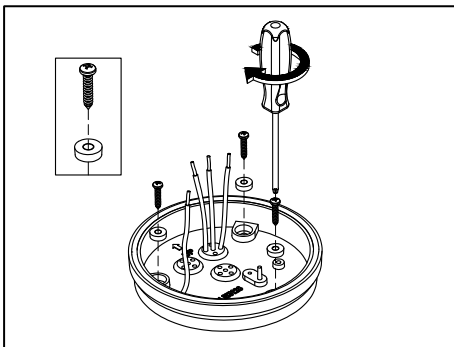
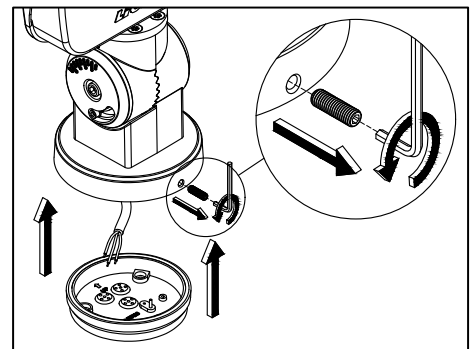
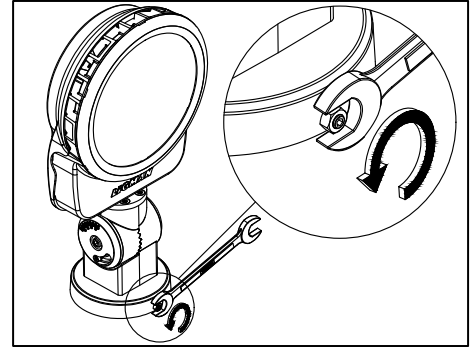
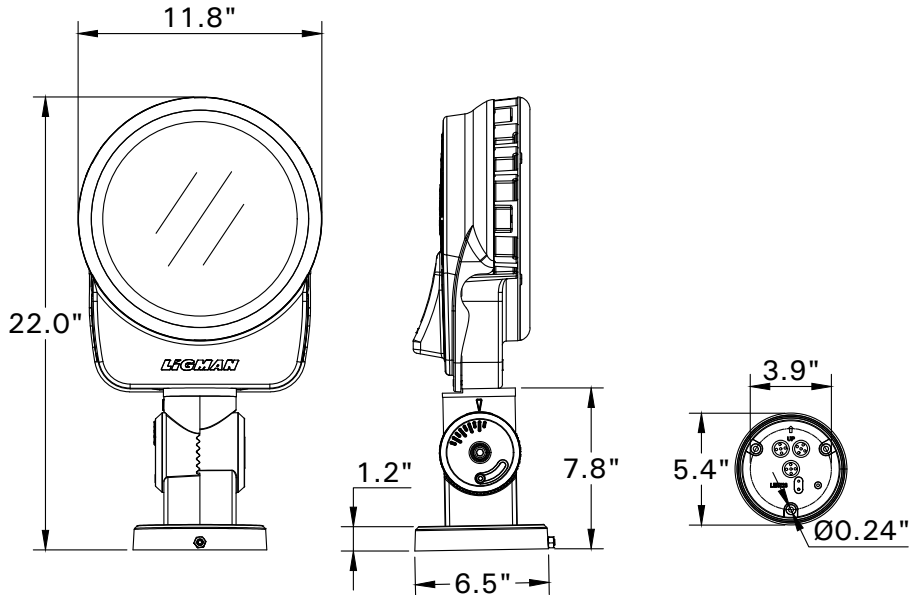

## Notice to installer :

**WIRING INSTRUCTIONS** Warning : RISK OF FIRE AND ELECTRICAL SHOCK. : FIXTURE MUST BE INSTALLED BY A QUALIFIED ELECTRICIAN ONLY>FIXTURE IS INTENDED FOR INSTALLATION IN ACCORDANCE WITH THE NATIONAL ELECTRICAL CODE, LOCAL AND FEDERAL CODE SPECIFICATIONS. DISCONNECT POWER BEFORE SERVICING.

**Ligman Lighting USA**

7144 NE Progress Court, Hillsboro  
Oregon, 97124, USA  
Tel : 503 645 0500 | Fax : 503 645 8100

[www.ligmanlightingusa.com](http://www.ligmanlightingusa.com)

UQA-50011-PKM 27/10/25 REV.0

1/1

FM-TS-13-2/21-03-2568/Rev.5